

C1: Sessions
C2-C3: General Session
C4/BC Hall: ASH
Central/Registration

**B1-B4: Exhibits/Product Theaters/
ASH Café**
B5: Posters

A1: Large Session Room
A2-A3: Exhibitor Meeting Rooms

Exhibit Level Overview

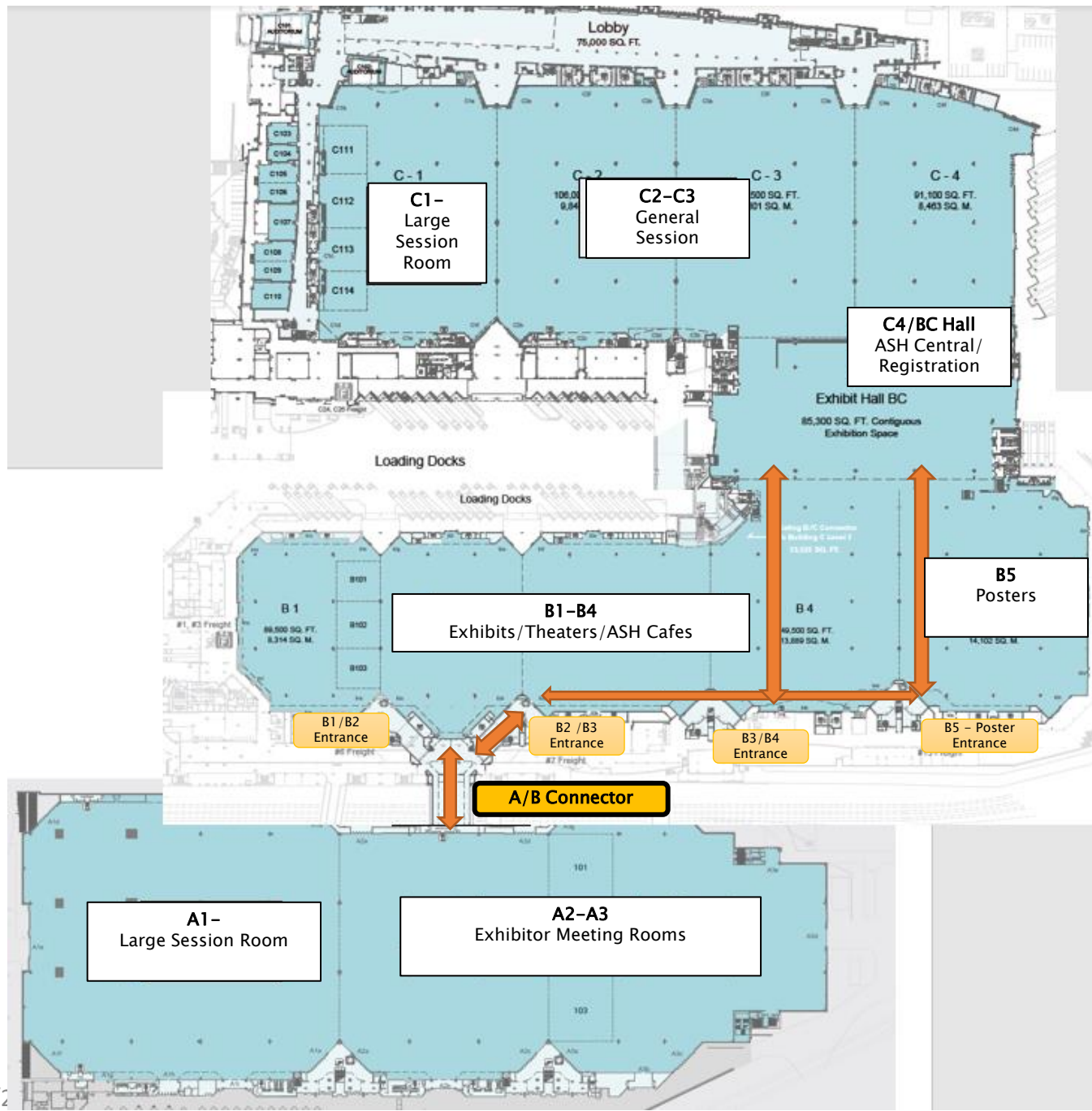

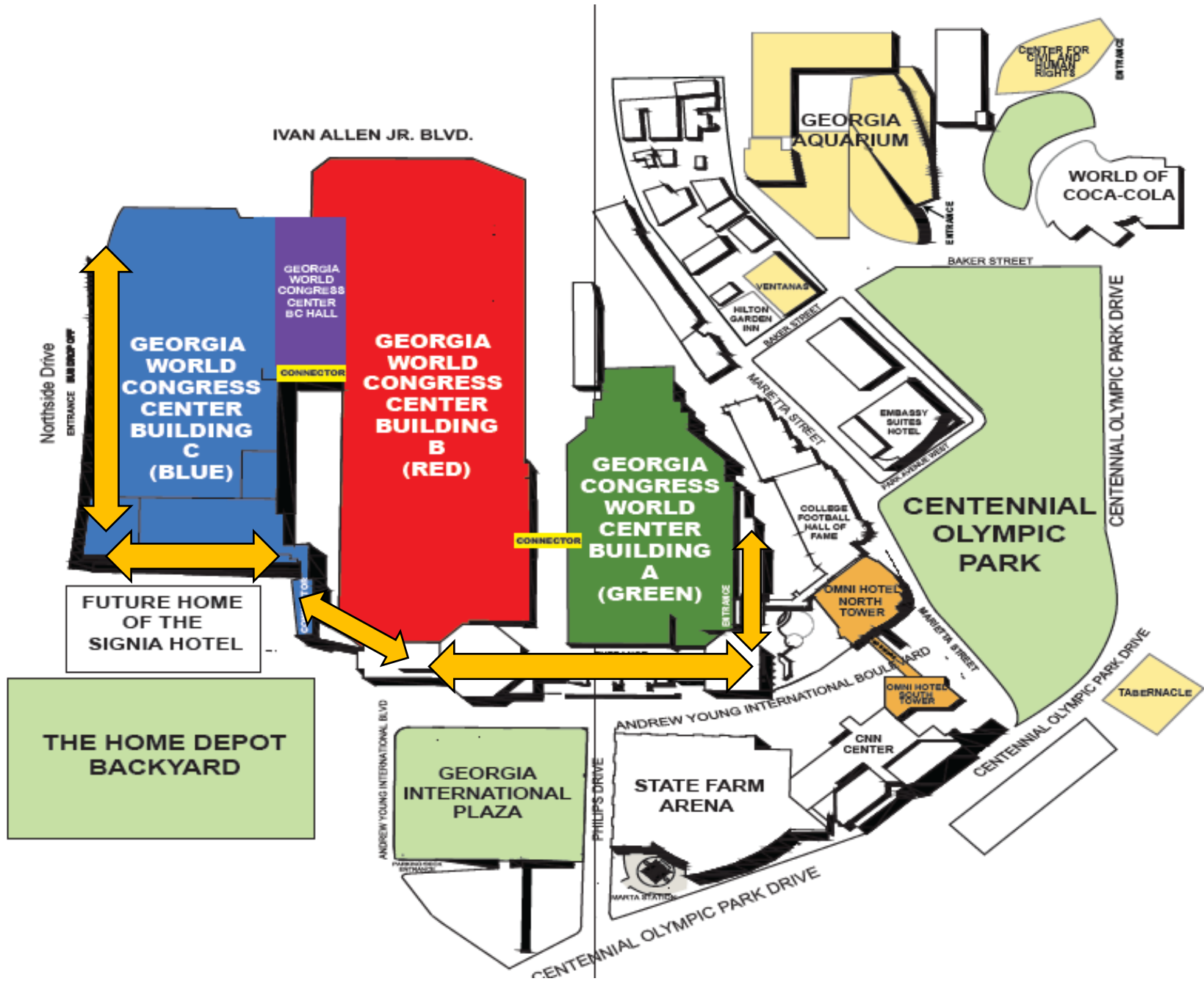

Street Level Overview

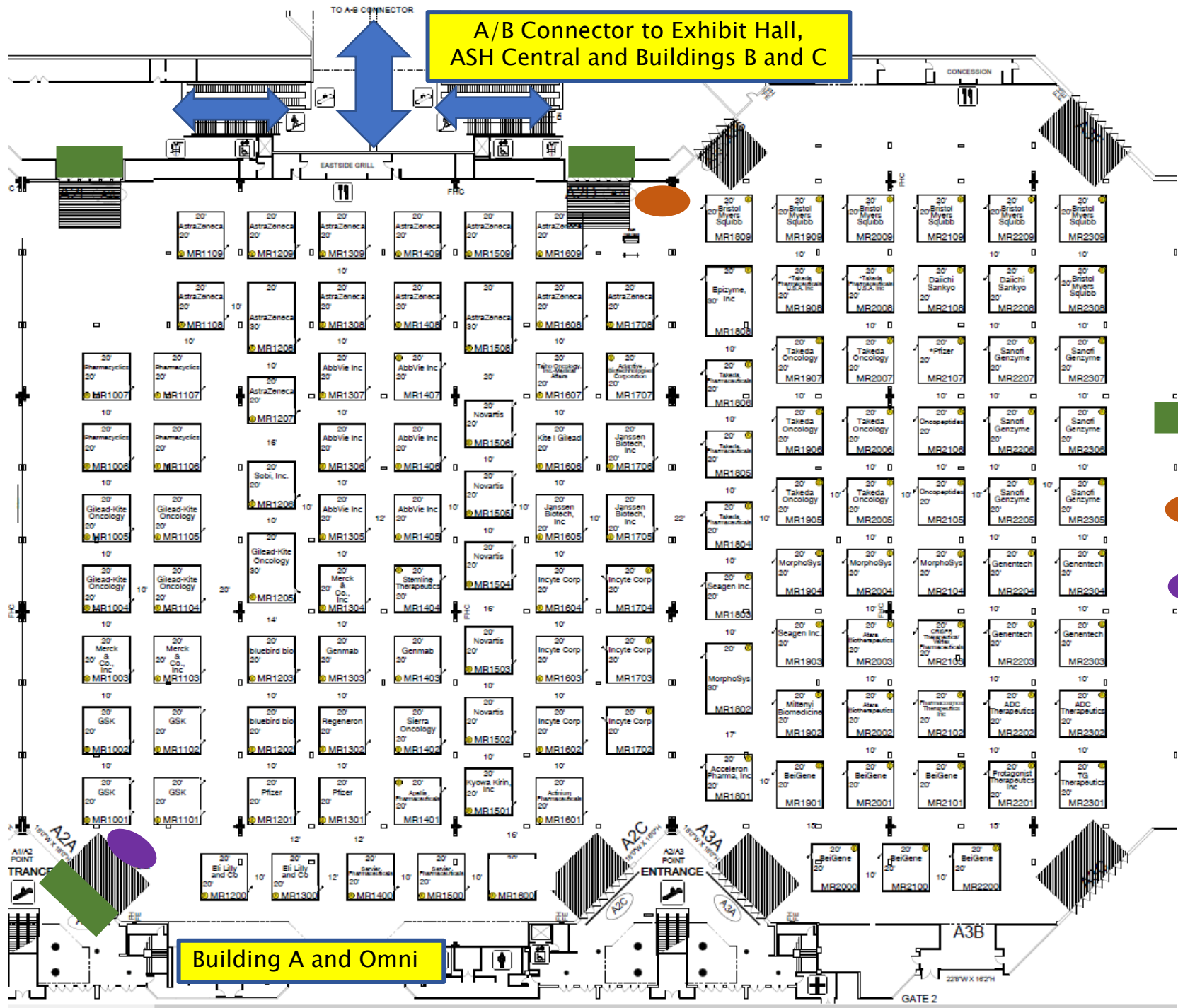

A/B Connector to Exhibit Hall,
ASH Central and Buildings B and C



Hall A1
Session Room

-  Entrance to Exhibitor Meeting Rooms
-  A3 Meeting Room Help Desk
PASSCODE PICK-UP
-  A2 Meeting Room Help Desk

Building A and Omni

GATE 2

Exhibitor Meeting Rooms – Hours

- Friday, December 10: 8:00 a.m. – 4:30 p.m. *(for staff meetings and setup only)*
- Saturday, December 11: 7:00 a.m. – 7:00 p.m.
- Sunday, December 12: 7:00 a.m. – 7:00 p.m.
- Monday, December 13: 7:00 a.m. – 2:00 p.m.

Exhibitor meeting rooms may be used for staff meetings and set up only on Friday, December 10. Please do not schedule meetings with attendees in your meeting room(s) on Friday, December 10 as they will not be permitted access to the Exhibitor Meeting Room area.

Official 63rd ASH Annual Meeting and Exposition Badges are required to access the Exhibitor Meeting Room area.